

# F5500 RFI Filters

Wide Band

SINGLE PHASE FILTERS



Ideal for Linear and Switching Power Supplies

## Features:

- FCC and VDE Level "A" Applications
- High Inductance Single Coil Design Provides High Common Mode and Differential Mode Performance Above 150KHz
- High-Frequency Construction Techniques Maintain >50dB Insertion Loss from 10MHz to 1GHz
- Compact, Space-Saving Package Available in 3, 6 and 10-Amp Ratings

## F5500 Simplified Schematic

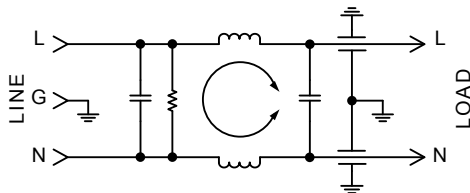

## Specifications:

**Rated Voltage:** 250VAC Maximum - 50/60 Hz

**Rated Current:**

115VAC	250VAC
3A	3A
6A	4A
10A	6A

**Current Overload:** 6X for 8 seconds

**Hi-Pot Test (1 min):**

Line to Ground	1400VDC
Line to Line	1450VDC

**Insulation Resistance:**  $9 \times 10^9 \Omega$  at 100VDC

**Ambient Temperature:** 40°C Max. at rated current

**Humidity Range:** 0% to 95% R.H.

**Termination:**

C: IEC Receptacle  
G: Wire Wrap/Solder

**Maximum Leakage Current:**

Each Line to Ground	<b>F5500</b>
115VAC, 60Hz:	0.25mA
250VAC, 60Hz:	0.50mA

**Agency Approvals:**



Nominal Current Rating	Part Number	Termination Line/Load
3A	F5500CG03	IEC/ Solder Tab
6A	F5500CG06	IEC/ Solder Tab
10A	F5500CG10	IEC/ Solder Tab

**F5500 SERIES  
TYPICAL COMMON MODE  
INSERTION LOSS — dB  
(50 OHM CIRCUIT)**

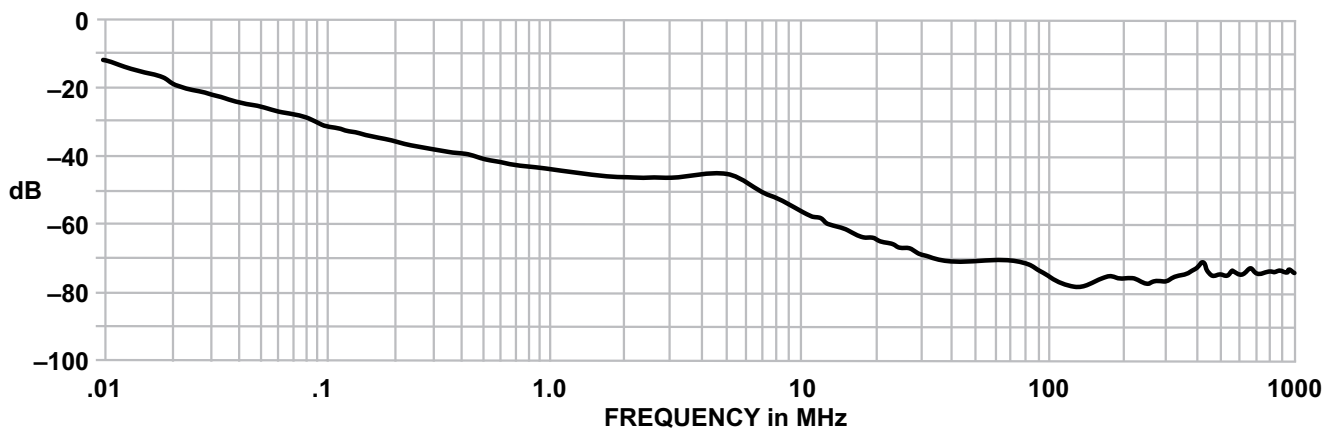

**F5500CG** (3, 6 and 10Amp) Dimensions

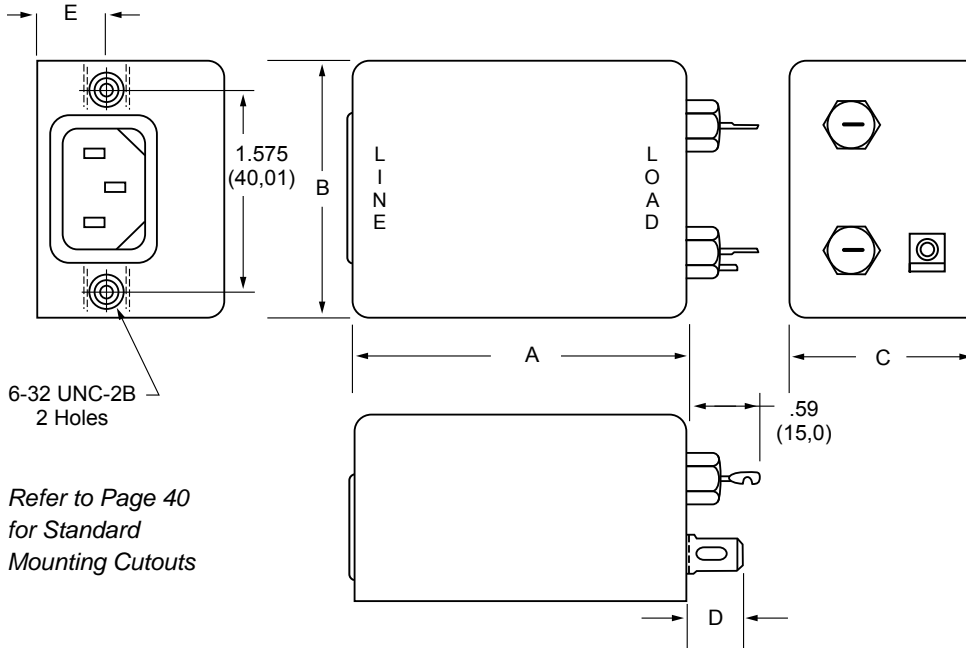

6-32 UNC-2B  
2 Holes

Refer to Page 40  
for Standard  
Mounting Cutouts

Amps	A	B	C	D	E
3A	2.000 (50,8)	2.000 (50,8)	1.500 (38,2)	.450 (11,4)	.565 (14,3)
6A	2.88 (73,1)	2.13 (54,1)	1.500 (38,2)	.450 (11,4)	.565 (14,3)
10A	2.88 (73,1)	2.13 (54,1)	1.500 (38,2)	.450 (11,4)	.565 (14,3)

**F5501CG** (3, 6 and 10Amp) Dimensions  
with attached mounting plate

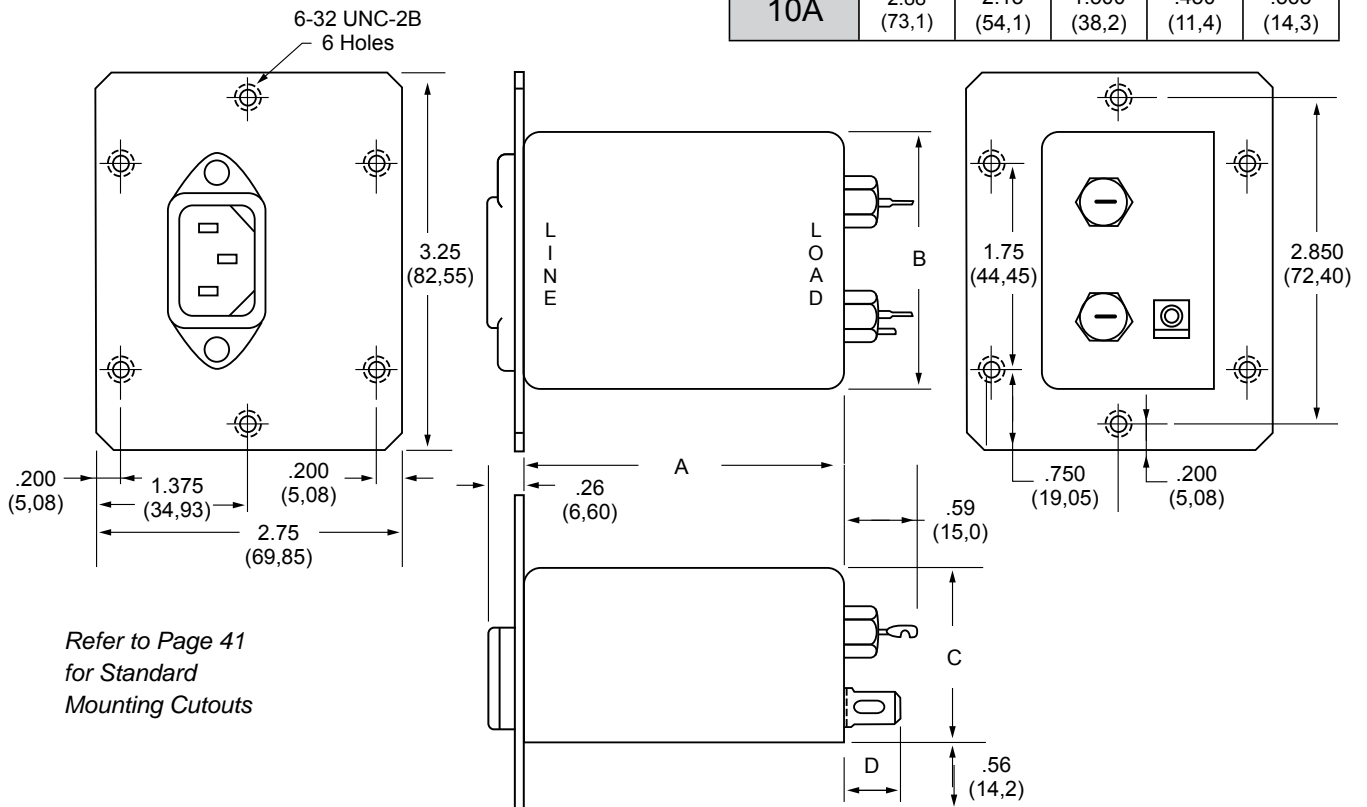

Refer to Page 41  
for Standard  
Mounting Cutouts

Dimensions are in inches and millimeters  
unless otherwise specified.  
Values in parentheses are metric equivalents.



# Standard Mounting Cutouts

## F1200CA, F1300CA, F1400CA, F1500CA, F1600CA, F1700CA

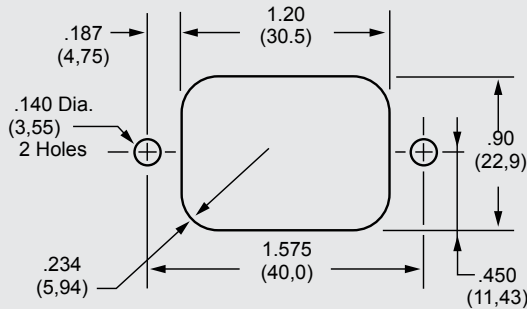

## F1500FA, F1600FA,

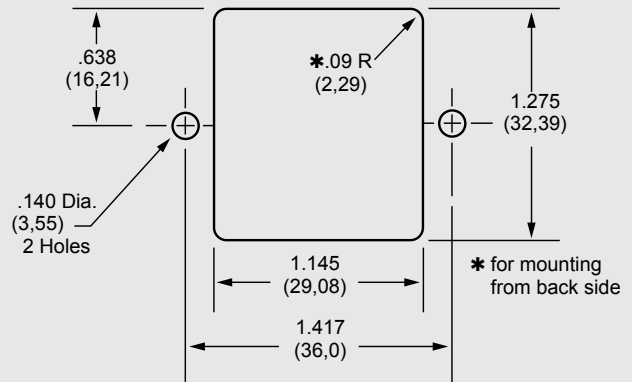

### How to Order

The Curtis part numbering system is made up of four elements. Each element denotes a specific requirement (mechanical or electrical) which, when properly sequenced, fully identifies the required catalog filter. As shown, the first five alpha/numeric characters denote the series type; the sixth character (alpha) denotes the type of line termination; the seventh character (alpha) denotes the type of load termination; the last two characters (numeric) denote the current rating.

Compose your part number as follows: Select the series required, add two alpha character for the line and load termination, followed by two numeric characters for the required current rating. For example, F1100AB06 completely identifies an F1100 series filter with quick connects on line side and wire leads on load side, with a 6-amp rating.

## F1300CP, F1600CP

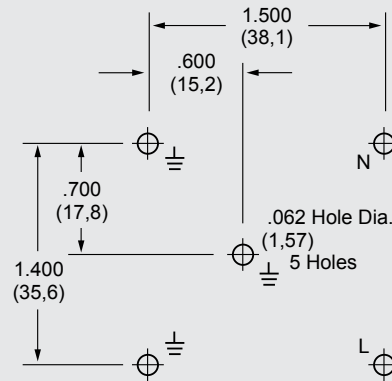

## F5500/5600/5700 SERIES

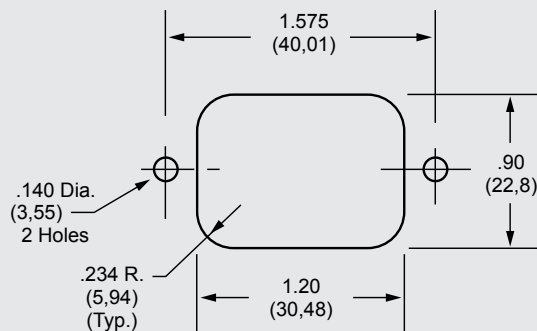

SINGLE PHASE FILTERS

F1100	X	X	X
SERIES	LINE TERMINATION	LOAD TERMINATION	CURRENT RATING
PE = Power Entry PM = Medical Power Entry	A = Quick Connects B = Wire Leads C = IEC Connector D = Screw Terminals (20 & 30 amp only) F = Fused IEC P = Printed Circuit Pins W = Dual Fused IEC J = Switched IEC	A = Quick Connects B = Wire Leads D = Screw Terminals (20 & 30 amp only) P = Printed Circuit Pins S = Solder Tab	01 = 1 Amp 03 = 3 Amps 06 = 6 Amps 10 = 10 Amps 15 = 15 Amps 20 = 20 Amps 30 = 30 Amps



### F5100 SERIES

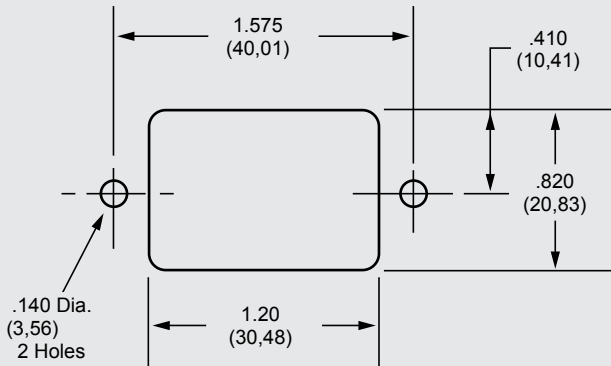

### F5200 SERIES

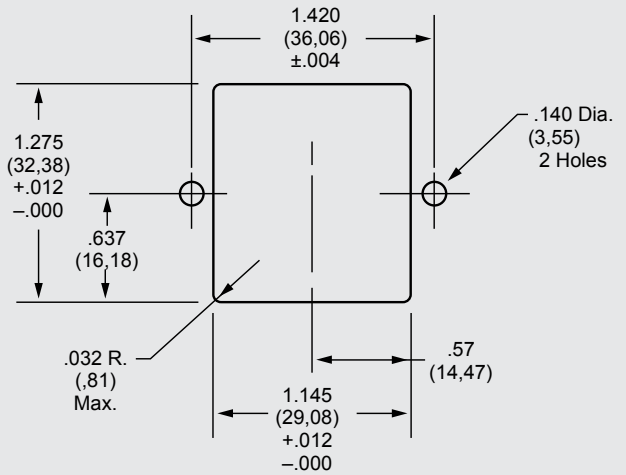

### F5101 SERIES

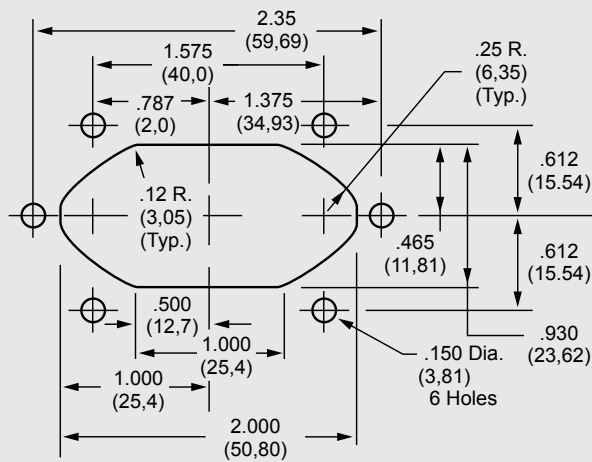

### F5201 SERIES

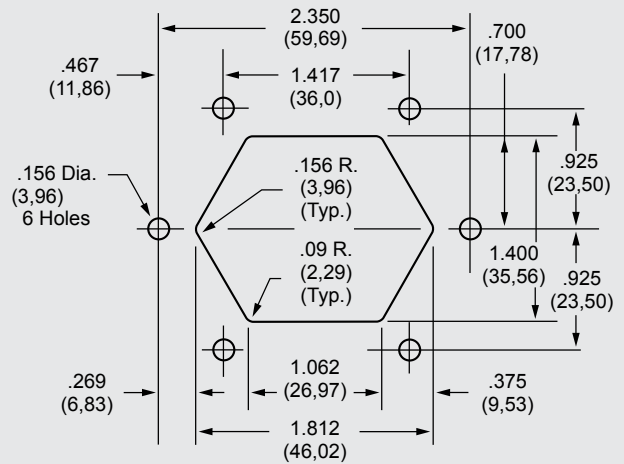

### F5501/5601/5701 SERIES

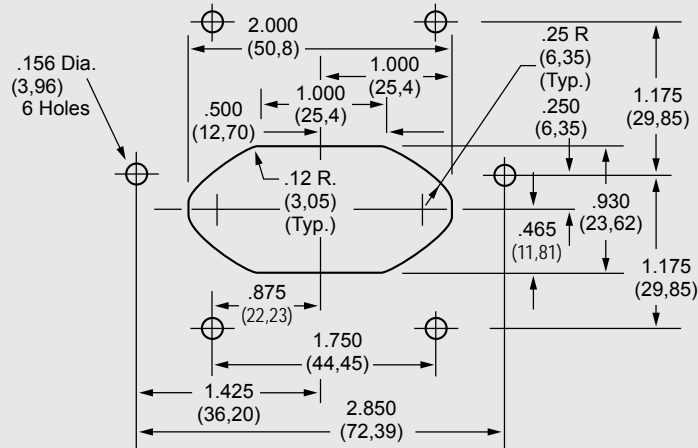

NOTE: Tolerance for all dimensions unless otherwise specified: .XXX three place ± .004, .XX two place ± 0.10

Dimensions are in inches and millimeters unless otherwise specified. Values in parentheses are metric equivalents.



**Curtis Industries**  
A Division of Powers Holdings, Inc.

1-800-657-0853