

## Screwless Single-Multi Level

- **Plastic Body:** Polyamide 66.6 VO
- **Internal Bus:** Tin-plated copper
- **Spring:** Stainless steel
- **Tracking Resistance:**  
IEC 112: CTI > 600  
VDE 0303: KB > 600

### 6102300 2.5/5 Feed Through

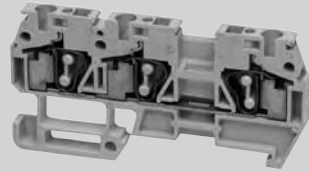

### 6102310 2.5/5 Feed Through

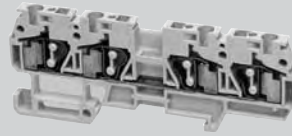

### 6202100 6/8 Feed Through

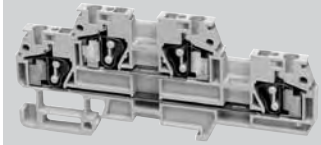

<b>Dimensions</b>	68.5 mm (L) x 28.5 mm (H) x 5 mm (W)			87.5 mm (L) x 28.5 mm (H) x 5 mm (W)			98 mm (L) x 37.5 mm (H) x 5 mm (W)		
<b>Stripping Length</b>	12 mm			12 mm			12 mm		
<b>Connecting Capacity</b>	Solid conductors mm <sup>2</sup> 1-2.5 Stranded conductors mm <sup>2</sup> 1-2.5			Solid conductors mm <sup>2</sup> 1-2.5 Stranded conductors mm <sup>2</sup> 1-2.5			Solid conductors mm <sup>2</sup> 1-2.5 Stranded conductors mm <sup>2</sup> 1-2.5		
<b>Gauges</b>	A3			A3					
<b>Approvals</b>									
<b>Wire Range</b>	24-12 AWG	24-12 AWG		24-12 AWG	24-12 AWG		24-12 AWG	24-12 AWG	
<b>Voltage Rating</b>	600V	600V	630V	600V	600V	630V	600V	600V	630V
<b>Current Rating</b>	20A	20A	24A	20A	20A	24A	20A	20A	24A
<b>ACCESSORIES</b>	<b>Cat. No.</b>			<b>Cat. No.</b>			<b>Cat. No.</b>		
<b>Available Colors</b>	6102300 – Gray 6102301 – Blue			6102100 – Gray			6102100 – Gray		
<b>End Plate</b> Qty. pk. 25	6800025 – 50 mm (L) x 23 mm (H) x 1.5 mm (W)			6800026 – 50 mm (L) x 23 mm (H) x 1.5 mm (W)			6800027 – 50 mm (L) x 23 mm (H) x 1.5 mm (W)		
<b>End Bracket</b> Qty. pk. 50	6804150 – 58 mm (L) x 36 mm (H) x 9 mm (W)			6804150 – 58 mm (L) x 36 mm (H) x 9 mm (W)			6804150 – 58 mm (L) x 36 mm (H) x 9 mm (W)		
<b>Jumper-Bar</b> Qty. pk. 10	6801050			6801050			6801050		

